

AERODROME GROUND MOVEMENT AND PARKING CHART - ICAO

APRON ELEV 243

TWR 124.205  
118.505  
ATIS 129.055

KAUNAS (EYKA)

Changes: new ACFT stands added; manoeuvring area, ATC service boundary, TWY B, taxiing routes U, P changed; P1 intermediate holding position from TWY B to Apron added; obstacles updated.

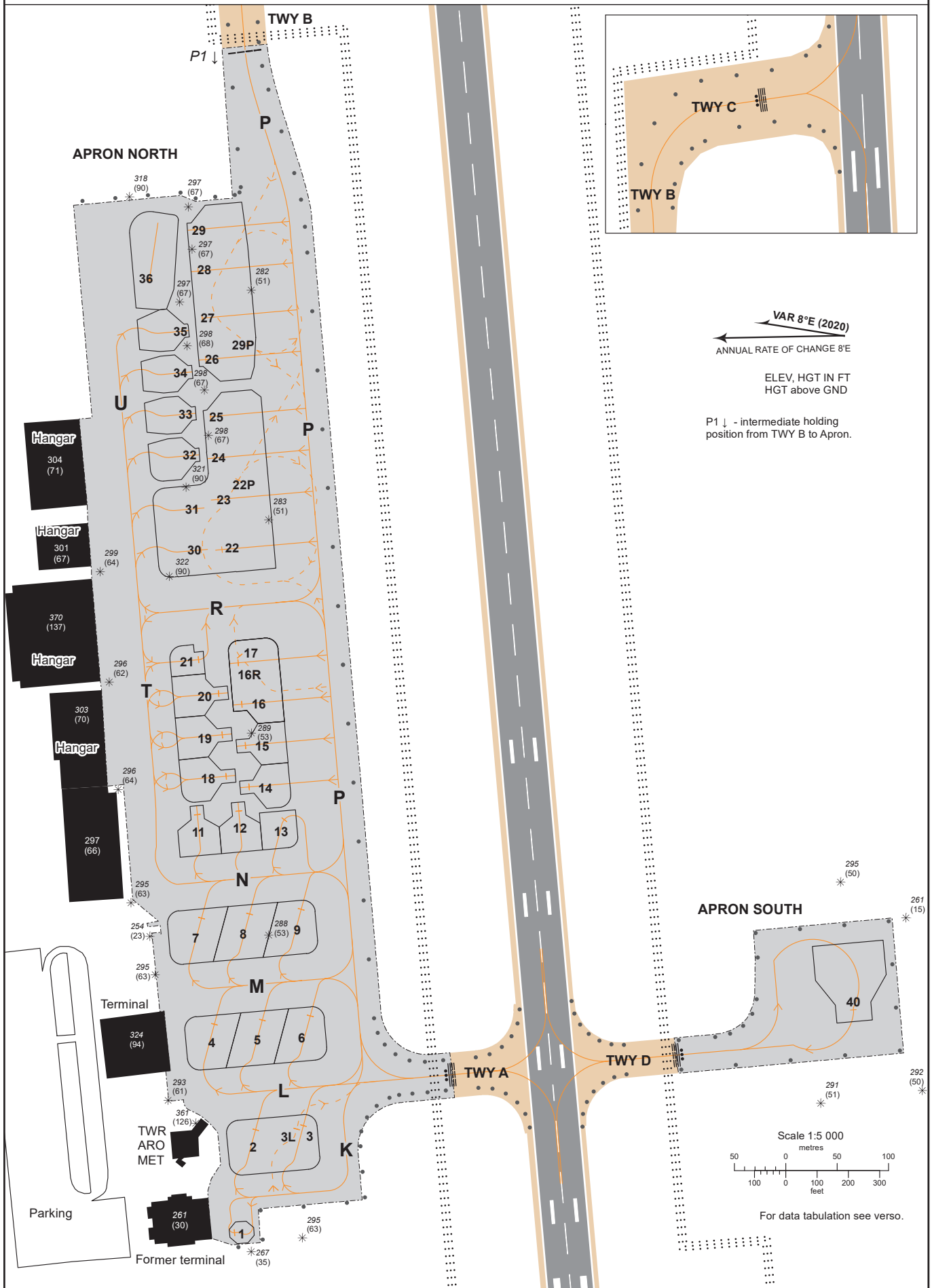

## AERONAUTICAL DATA TABULATION

## ACFT STANDS

Stand	Coordinates	Bearing Strength PCR	Max wing span, M	Remarks
1	54 57 57.86N 024 04 15.56E	5700 MTOM (kg)	15	Self manoeuvring (MTOW 5700 kg)
2	54 57 57.50N 024 04 20.33E	868/R/A/W/T	36	Self manoeuvring
3	54 57 56.19N 024 04 20.38E	868/R/A/W/T	36	Self manoeuvring
3L	54 57 56.30N 024 04 20.90E	844/F/A/W/T	65	Self manoeuvring. For CAT D and CAT E ACFT parking stands 2 and 3 have to be empty.
4	54 57 58.80N 024 04 26.05E	771/R/A/W/T	36	Self manoeuvring
5	54 57 57.36N 024 04 26.19E	599/R/A/W/T	36	Self manoeuvring
6	54 57 55.97N 024 04 26.32E	565/F/A/W/T	36	Self manoeuvring
7	54 57 59.30N 024 04 31.80E	868/R/A/W/T	36	Self manoeuvring
8	54 57 57.80N 024 04 32.00E	655/F/A/W/T	36	Self manoeuvring
9	54 57 56.10N 024 04 32.20E	655/F/A/W/T	36	Self manoeuvring
11	54 57 59.20N 024 04 37.60E	655/F/A/W/T	36	Taxi in/Push back
12	54 57 57.90N 024 04 37.80E	421/F/A/W/T	36	Taxi in/Push back
13	54 57 56.60N 024 04 37.60E	169/F/A/W/T	24	Self manoeuvring
14	54 57 57.10N 024 04 40.00E	565/F/A/W/T	36	Taxi in/Push back
15	54 57 57.20N 024 04 42.30E	829/R/A/W/T	36	Taxi in/Push back
16	54 57 57.30N 024 04 44.60E	542/R/A/W/T	36	Taxi in/Push back
16R	54 57 57.70N 024 04 46.70E	649/R/A/W/T	52	Self manoeuvring. Parking stands 16 and 17 have to be empty.
17	54 57 57.50N 024 04 46.80E	567/R/A/W/T	36	Taxi in/Push back
18	54 57 58.90N 024 04 40.50E	773/R/A/W/T	36	Taxi in/Push back
19	54 57 59.00N 024 04 42.70E	649/R/A/W/T	36	Taxi in/Push back
20	54 57 59.00N 024 04 45.00E	753/R/A/W/T	36	Taxi in/Push back
21	54 57 59.20N 024 04 46.90E	228/R/A/W/T	24	Self manoeuvring
22P-1	54 57 57.94N 024 04 56.76E	1174/R/A/W/T	65	Self manoeuvring. Parking stands 22, 23, 24, 25, 30 and 31 have to be empty.
22P-2	54 57 57.98N 024 04 56.64E			
22	54 57 58.46N 024 04 52.95E	1174/R/A/W/T	36	Taxi in/Push back
23	54 57 58.59N 024 04 55.69E	1174/R/A/W/T	36	Taxi in/Push back
24	54 57 58.70N 024 04 57.96E	1174/R/A/W/T	36	Taxi in/Push back
25	54 57 58.82N 024 05 00.23E	1174/R/A/W/T	36	Taxi in/Push back
26	54 57 58.97N 024 05 03.36E	1174/R/A/W/T	36	Taxi in/Push back
27	54 57 59.08N 024 05 05.63E	792/R/A/W/T	36	Taxi in/Push back
28	54 57 59.21N 024 05 08.21E	792/R/A/W/T	36	Taxi in/Push back
29	54 57 59.32N 024 05 10.48E	792/R/A/W/T	36	Taxi in/Push back
29P	54 57 57.63N 024 05 04.21E	792/R/A/W/T	52	Self manoeuvring. Parking stands 26, 27, 28 and 29 have to be empty.
30	54 57 59.12N 024 04 52.93E	1174/R/A/W/T	36	Taxi in/Push back
31	54 57 59.24N 024 04 55.20E	1174/R/A/W/T	36	Taxi in/Push back
32	54 57 59.38N 024 04 58.11E	868/R/A/W/T	36	Taxi in/Push back
33	54 57 59.49N 024 05 00.38E	868/R/A/W/T	36	Taxi in/Push back
34	54 57 59.61N 024 05 02.65E	868/R/A/W/T	36	Taxi in/Push back
35	54 57 59.72N 024 05 04.92E	868/R/A/W/T	36	Taxi in/Push back
36	54 58 00.74N 024 05 07.71E	868/R/A/W/T	36	Tow in/Tow out
40	54 57 38.59N 024 04 27.71E	745/F/A/W/T	65	Self manoeuvring

Note: ACFT stands 21-36, 40 coordinates of the stop position of the nose landing gear.

## TAXIING ROUTES

Route	Description	Max wing span, M	ACFT stand and ACFT facing direction
K	From TWY A to ACFT stand 3L. From ACFT stand 3L to ACFT stand 2.	65 36	2, 3, 3L - facing east; 1 - facing north
L	From TWY A to western part of ACFT stand 4.	36	4, 5, 6 - facing east
M	From taxiing route P to western part of ACFT stand 7.	36	7, 8, 9, - facing east
N	From taxiing route P to intersection with taxiing route T.	36	11, 12, 13 - facing east
P	The main taxiing route starts from the TWY A up to the TWY B. From taxiing route P goes all other taxiing routes.	62.6	14, 15, 16, 16R, 17, 22, 23, 24, 25, 26, 27, 28, 29 - facing north, 22P - facing east, 29P - facing west
R	From ACFT stand 16R to intersection with taxiing route P. From ACFT stand 16R to intersection with taxiing routes T/U.	52 36	NIL
T	From intersection with taxiing routes R/U to intersection with taxiing route N.	36	18, 19, 20, 21 - facing south
U	From intersection with taxiing routes R/T to ACFT stand 36.	36	30, 31, 32, 33, 34, 35 - facing south, 36 - facing west

## Restrictions

K	Taxiing of CAT D and CAT E aircraft allowed only when parking stands 1, 2 and 3 are empty. Taxiing of CAT E aircraft allowed with "Follow-me" service only.
P	Taxiing of CAT D and CAT E aircraft allowed only when parking stands 6 and 9 are empty.
U	Movement to/from ACFT stand 36 is allowed only by push back tug.

Changes: ACFT stands added; bearing strength changed to PCR; taxiing routes descriptions and restrictions.