

AERODROME CHART - ICAO

AERODROME ELEV 259

54° 57' 50" N
024° 05' 05" E

TWR 124.205
118.505
ATIS 129.055

KAUNAS (EYKA)

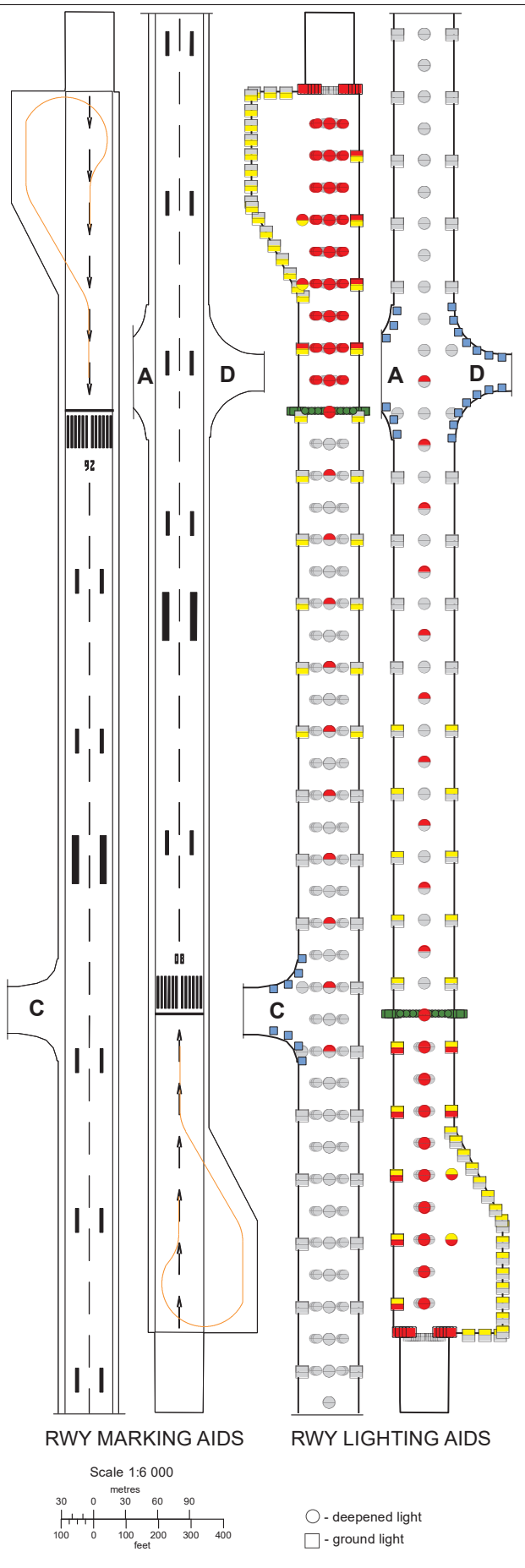
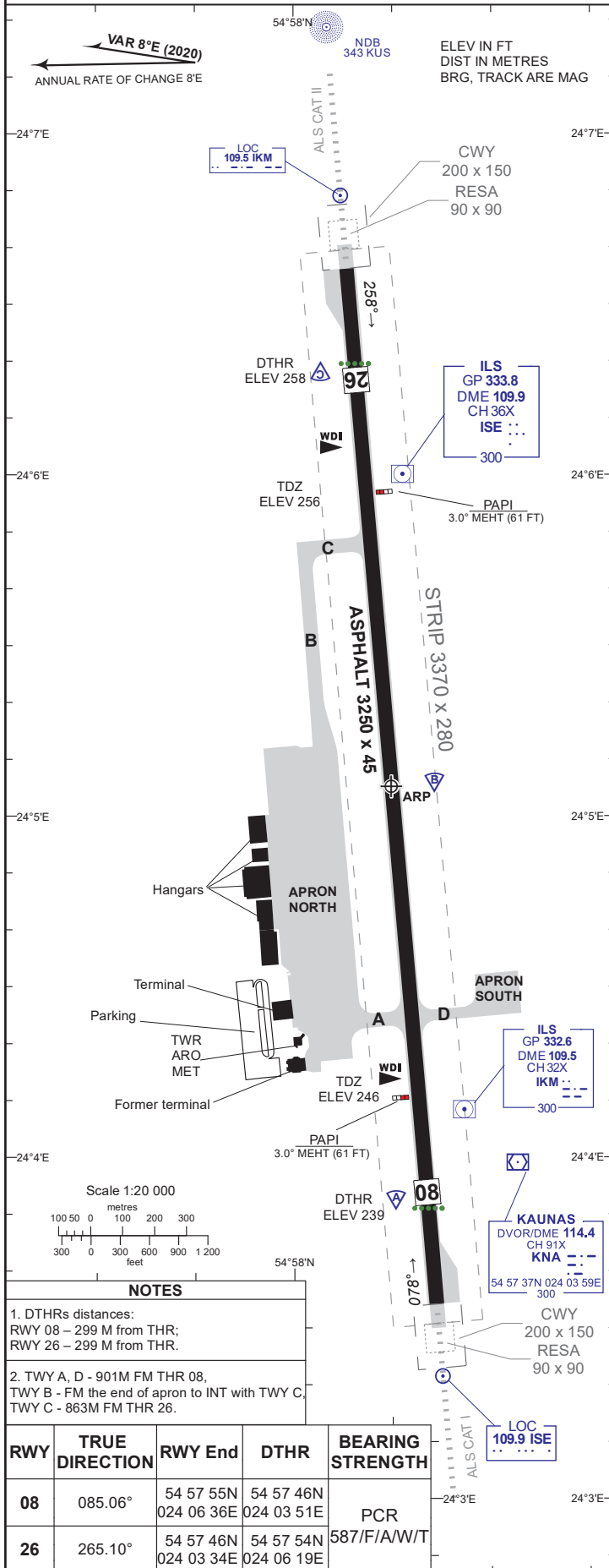

Changes: apron north; RWY bearing strength and surface; TDZ ELEV added.

NOTES

- DTHR distances:
RWY 08 – 299 M from THR;
RWY 26 – 299 M from THR.
- TWY A, D - 901M FM THR 08,
TWY B - FM the end of apron to INT with TWY C,
TWY C - 863M FM THR 26.

RWY	TRUE DIRECTION	RWY End	DTHR	BEARING STRENGTH
08	085.06°	54 57 55N 024 06 36E	54 57 46N 024 03 51E	PCR
26	265.10°	54 57 46N 024 03 34E	54 57 54N 024 06 19E	587/F/A/W/T

AERONAUTICAL DATA TABULATION

TAXIWAYS

TWY	Width (M)	Bearing Strength PCR	Surface	Centre Line Points
A	23	655/F/A/W/T	Asphalt	54 57 48.81N 024 04 24.55E 54 57 49.87N 024 04 24.39E 54 57 51.19N 024 04 24.18E 54 57 52.80N 024 04 23.92E
B	23	835/F/A/W/T	Asphalt	54 57 58.68N 024 05 43.80E 54 57 58.32N 024 05 32.28E 54 57 57.60N 024 05 20.40E
C	23	835/F/A/W/T	Asphalt	54 57 52.95N 024 05 47.82E 54 57 54.00N 024 05 47.70E 54 57 55.30N 024 05 47.50E 54 57 57.20N 024 05 47.20E 54 57 58.83N 024 05 43.91E
D	23	745/F/A/W/T	Asphalt	54 57 47.40N 024 04 24.74E 54 57 46.31N 024 04 24.91E 54 57 44.21N 024 04 25.22E 54 57 40.48N 024 04 25.76E

Changes: taxiways table added.